

STEP 1



Open your FlexFrame Box

STEP 2



Place one piece of acrylic flat, and center your photo. Double-sided tape can be used to secure the image to the acrylic.

STEP 3



Now that your image is aligned and centered, place the second piece of acrylic on top of your photo.

STEP 4



Carefully flip over the acrylic so that your photo is facing down

STEP 5

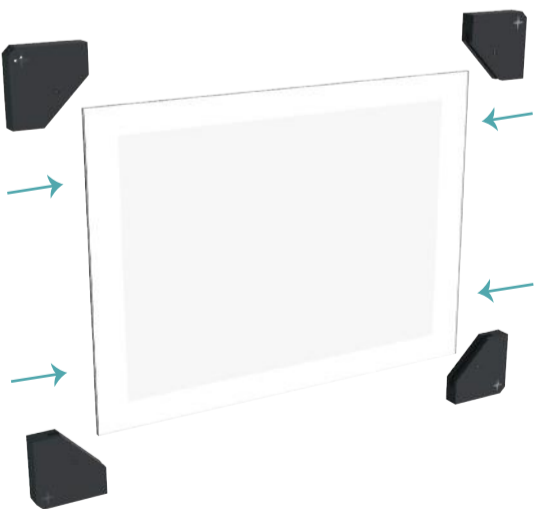

Slide each FlexFrame corner over each of the four corners of the assembled acrylic.

STEP 6

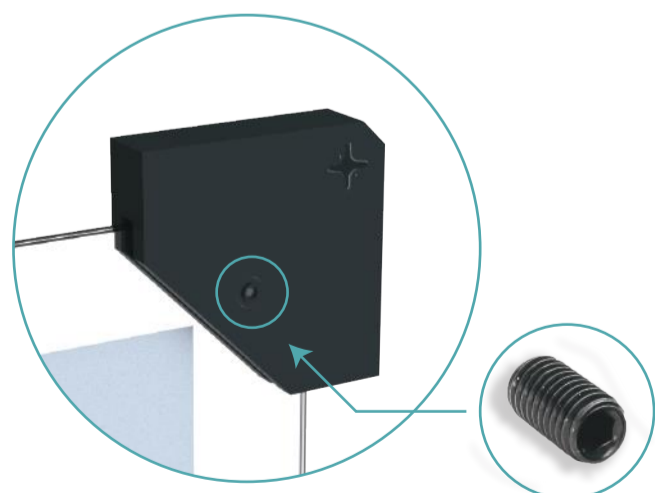

Screw comes pre-assembled within each corner

STEP 7

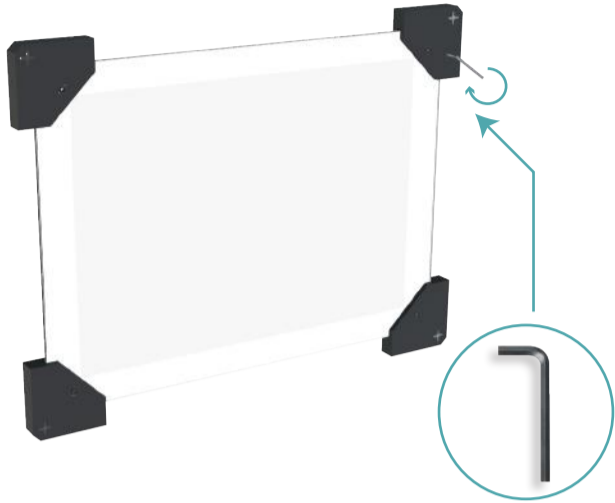

Using the Allen Wrench provided, fasten each screw slowly. Once you feel the screw hitting the acrylic, STOP! Do not over tighten the screws.

STEP 8



To confirm that each FlexFrame corner is properly secured, carefully lift up the picture by the top two corners

STEP 9



Using a level, align the picture on the wall.

STEP 10

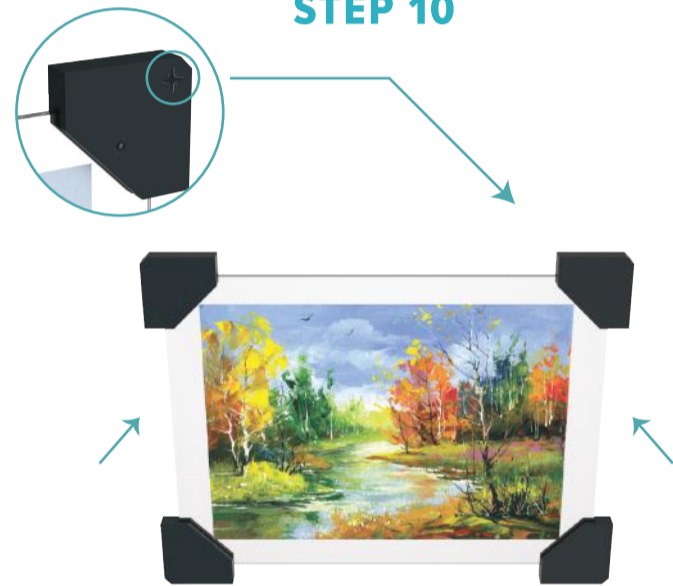

Using the cones on the back of the frame, push the corners against the wall to mark the nail location.

STEP 11

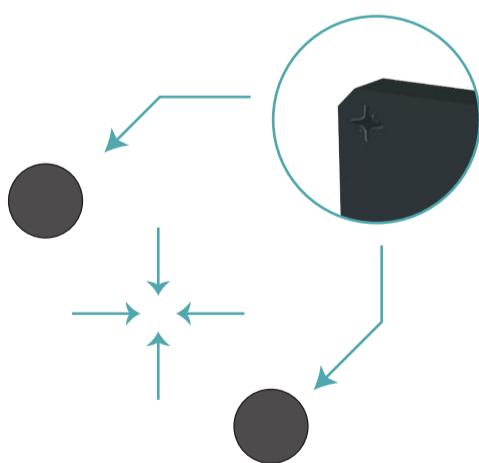

Find the two small indents on the wall, and insert your nail in the middle. Do this step twice – once for the top left corner and once for the top right corner.

STEP 12

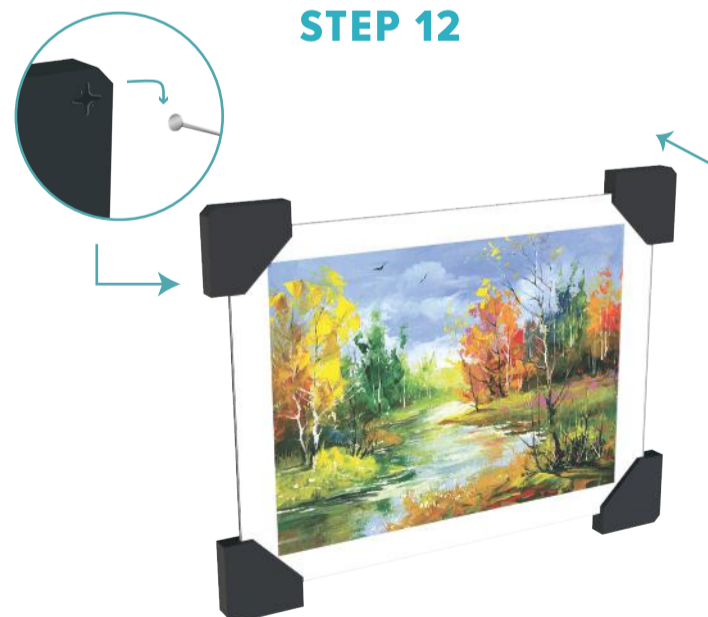

Hang your FlexFrame System on the nails. Each corner will slide over the nail which locks it in place.